

4 3 2 1

**MATERIAL & FINISH**

- 1 CONNECTOR BODY: BRASS, NICKEL PLATING
- 2 CENTER CONTACT: BRONZE, SILVER PLATED
- 3 INSULATOR: PTFE
- 4 RADIATOR: ALUMINIUM, BLACK

**ENVIRONMENTAL DATA:**

- 1 OPERATING TEMPERATURE RANGE: -55 °C~+125 °C
- 2 2015/863/(RoHS): COMPLIANT
- 3 1907/2006/EC(REACH) AND 1999/45/EC(REACH): COMPLIANT

**ELECTRICAL DATA:**

- 1 IMPEDANCE: 50 Ω
- 2 FREQUENCY RANGE: DC~6 GHz
- 3 VSWR: 1.45 MAX.
- 4 AVERAGE POWER: 600 WATTS AVERAGE TO 25°C AMBIENT TEMPERATURE, DERATED LINEARLY TO 60W @ 125°C
- 5 PEAK POWER: MAXIMUM POWER 10 KW @ 5μS(100μS MAX.) PULSE WIDTH WITH THE MAXIMUM 5% DUTY CYCLE

REVISIONS			
REV.	DESCRIPTION	DATE	APPROVED
A	INITIAL RELEASE	05/15/25	J. Q
B	CHANGED ELECTRICAL DATA	06/19/25	J. Q

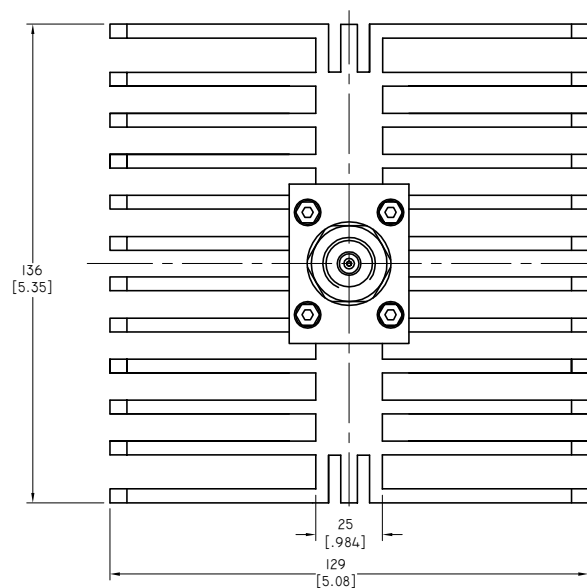
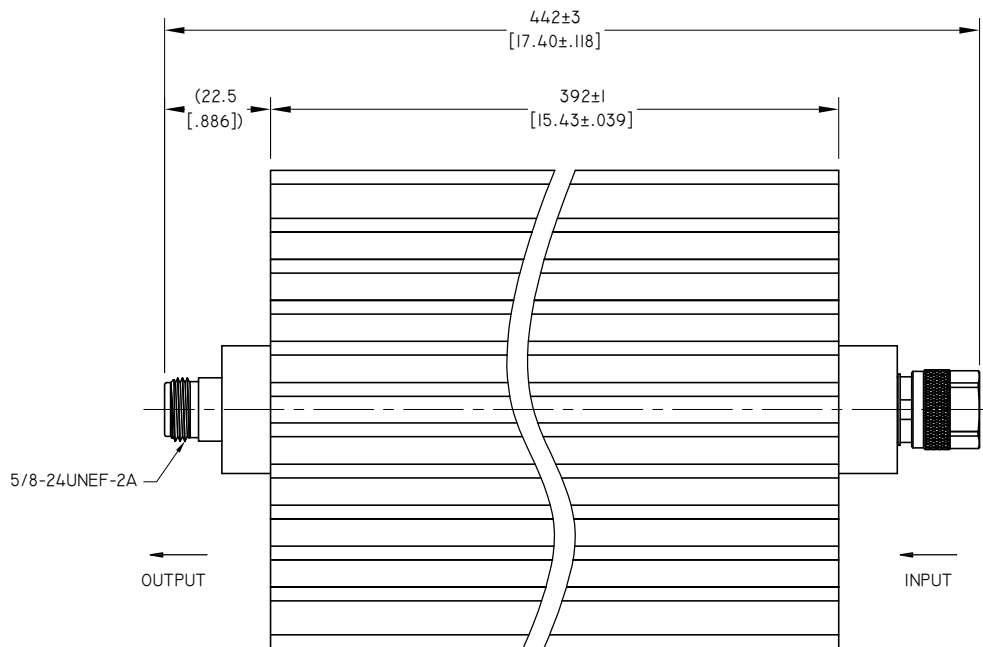

ANO 5I-60002-XX	
ATTENUATION VALUES	ACCURACY DC~6 GHz
10 DB	±3.0 DB
20 DB	±3.0 DB
30 DB	±3.0 DB
40 DB	±3.0 DB
50 DB	±3.0 DB

NOTE: XX REFER TO ATTENUATION VALUE IN DB

DRAWN	P. C	DATE	06/19/25
CHECKED	X. Y	DATE	06/19/25
APPROVED	J. Q	DATE	06/19/25
UNLESS OTHERWISE SPECIFIED DIMENSIONS ARE IN MILLIMETERS, DIMENSIONS IN [ ] ARE IN INCHES FOR CUSTOMER REFERENCE ONLY UNLESS OTHERWISE SPECIFIED TOLERANCE ARE:		THESE DRAWINGS AND SPECIFICATIONS ARE THE PROPERTY OF ANOISON ELECTRONICS LTD AND SHOULD NOT BE USED WITHOUT WRITTEN PERMISSION COPYRIGHT © 2025 ANOISON ELECTRONICS LTD	
.XX	±0.13 [.005"]		
.X	±0.20 [.008"]		
X	±0.50 [.019"]		
X°	±1°		
X"	±2°		

**TITLE**  
ATTENUATOR, N FEMALE TO MALE 600 WATTS UNI DIRECTIONAL, DC~6GHZ

**VIEW**

**PART NO.** ANO 5I-60002-XX

<b>SIZE</b> A3	<b>SCALE</b> 1:1	<b>SHEET</b> 1/1	<b>REV.</b> B
-------------------	---------------------	---------------------	------------------

D  
C  
B  
A

4 3 2 1