

4

3

2

1

MATERIAL & FINISH:

- 1. BODY: STAINLESS STEEL, PASSIVATED
- 2. CENTER CONTACT: BERYLLIUM COPPER ALLOY, GOLD PLATED
- 3. COUPLING NUT: STAINLESS STEEL, PASSIVATED
- 4. RETAINING RING: BERYLLIUM COPPER ALLOY, NICKEL PLATED
- 5. INSULATOR: PEI & PTFE

ENVIRONMENTAL DATA:

- 1. TEMPERATURE RANGE: -55°C~+165°C
- 2. 2011/65/EU (RoHS): COMPLIANT

REVISIONS			
REV.	DESCRIPTION	DATE	APPROVED
D	ADDED ANO 2111-3333-6	05/21/15	J. QU
E	DRAWING FORMAT CHANGED	07/24/17	J. QU
F	CHANGED COUPLING NUT DRAWINGS	09/24/19	J. QU

ELECTRICAL SPECIFICATIONS:

- 1. IMPEDANCE: 50 Ω
- 2. FREQUENCY RANGE: DC~27GHZ
- 3. VSWR: 1.10 MAX. DC~18GHZ
1.15 MAX. 18~27GHZ
- 4. DIELECTRIC WITHSTANDING VOLTAGE: 1000V

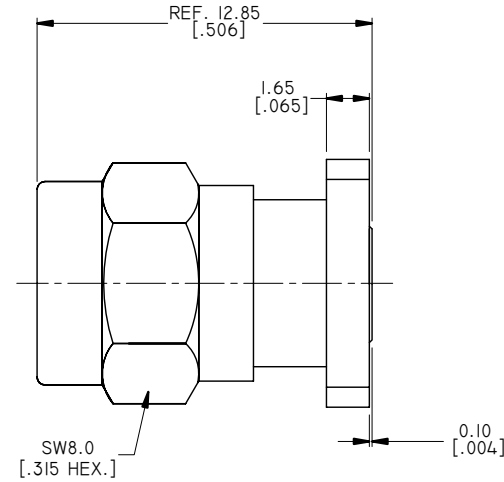
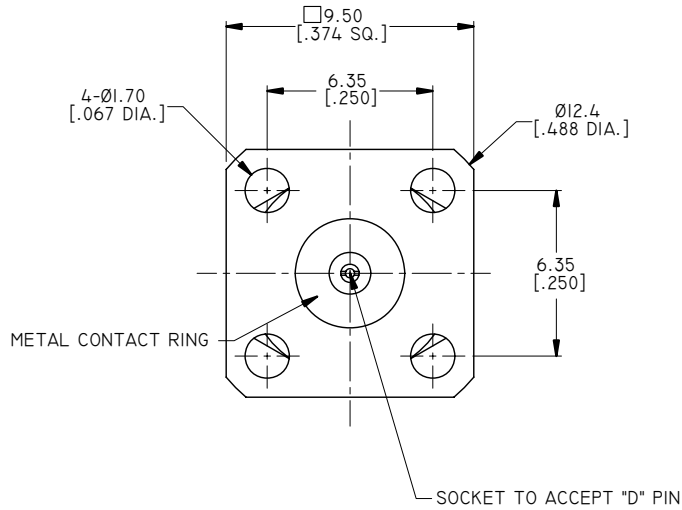

PART NO.	D	MAX. PIN DEPTH
ANO 2111-3333-1	Ø0.23 [.009 DIA.]	1.65 [.065]
ANO 2111-3333-2	Ø0.30 [.012 DIA.]	1.90 [.075]
ANO 2111-3333-3	Ø0.38 [.015 DIA.]	2.54 [.100]
ANO 2111-3333-4	Ø0.46 [.018 DIA.]	2.54 [.100]
ANO 2111-3333-5	Ø0.51 [.020 DIA.]	2.54 [.100]
ANO 2111-3333-6	Ø0.91 [.036 DIA.]	2.54 [.100]

DRAWN	P. CHEN	DATE	09/24/19
CHECKED	X. B. YANG	DATE	09/24/19
APPROVED	J. QU	DATE	09/24/19
UNLESS OTHERWISE SPECIFIED DIMENSIONS ARE IN MILLIMETERS, DIMENSIONS IN [] ARE IN INCHES FOR CUSTOMER REFERENCE ONLY UNLESS OTHERWISE SPECIFIED TOLERANCE ARE:		THESE DRAWINGS AND SPECIFICATIONS ARE THE PROPERTY OF ANOISON ELECTRONICS LTD AND SHOULD NOT BE USED WITHOUT WRITTEN PERMISSION COPYRIGHT © 2019 ANOISON ELECTRONICS LTD	
.XX	±0.13 [.005"]		
.X	±0.20 [.008"]		
X	±0.50 [.019"]		
.X°	±1°		
X°	±2°		



TITLE			
SMA STRAIGHT MALE, 4 HOLES FLANGE FIELD REPLACEABLE			
VIEW		PART NO.	
		ANO 2111-3333	
SIZE	SCALE	SHEET	REV.
A3	5:1	1/1	F

4

3

2

1